

.....

# PROJECT

.....

Messe Frankfurt  
Hall 12  
Frankfurt am Main

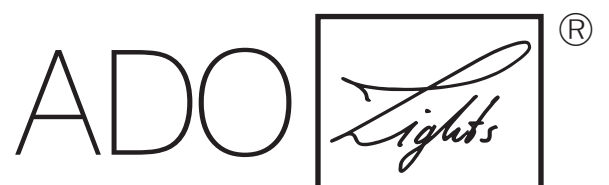

by TTC Timmler Technology

# MESSE FRANKFURT HALL 12

Frankfurt am Main

---



ARCHITECT | LIGHT PLANNER

kadawittfeldarchitektur, Aachen | Kardoff Ingenieure, Berlin

---

## Integrated Illumination installed on the inside of the Façade

Ceiling illumination with asymmetric light distribution without distracting stray light – installed on the inside of the façade

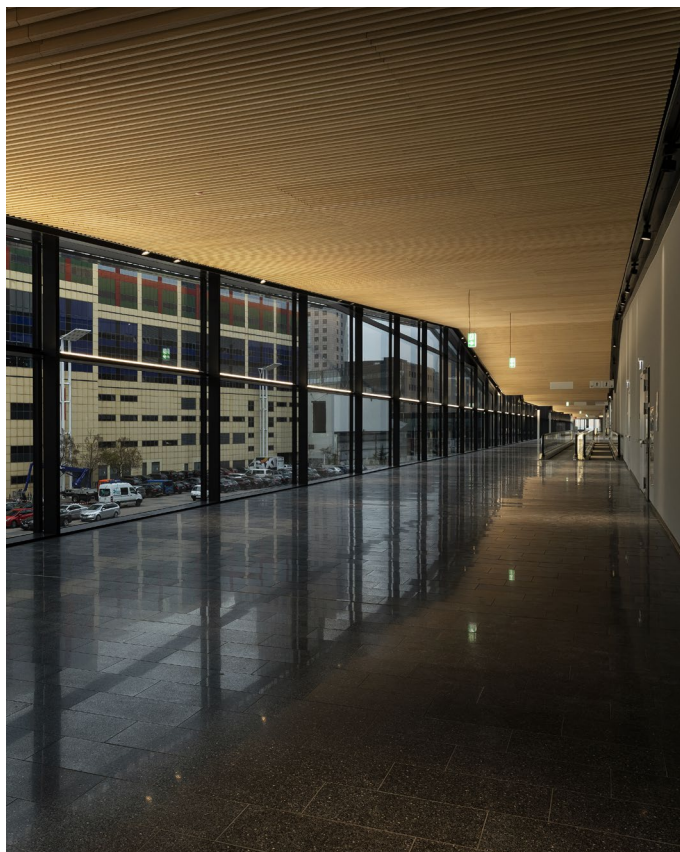

# MESSE FRANKFURT HALL 12

Frankfurt am Main

---



## PRODUCTS

Specification

---

## Products

- 380 m, LED surface-mounted/recessed luminaire FaMe12 indirect, housing made of aluminium equipped with Samsung LEDs 4.000 K, approx. 110 W, 12,460 lm, with clear PMMA cover, dimmable DALI, EVG integrated 230V, on front sides plug/connector for feed-through wiring resp. stringing together, housing according to RAL
- Dimension 100 x 30 mm (W x H), Length 4,800 mm incl. plug-connector, LED 4,200 mm, 2 units length 2,400 mm

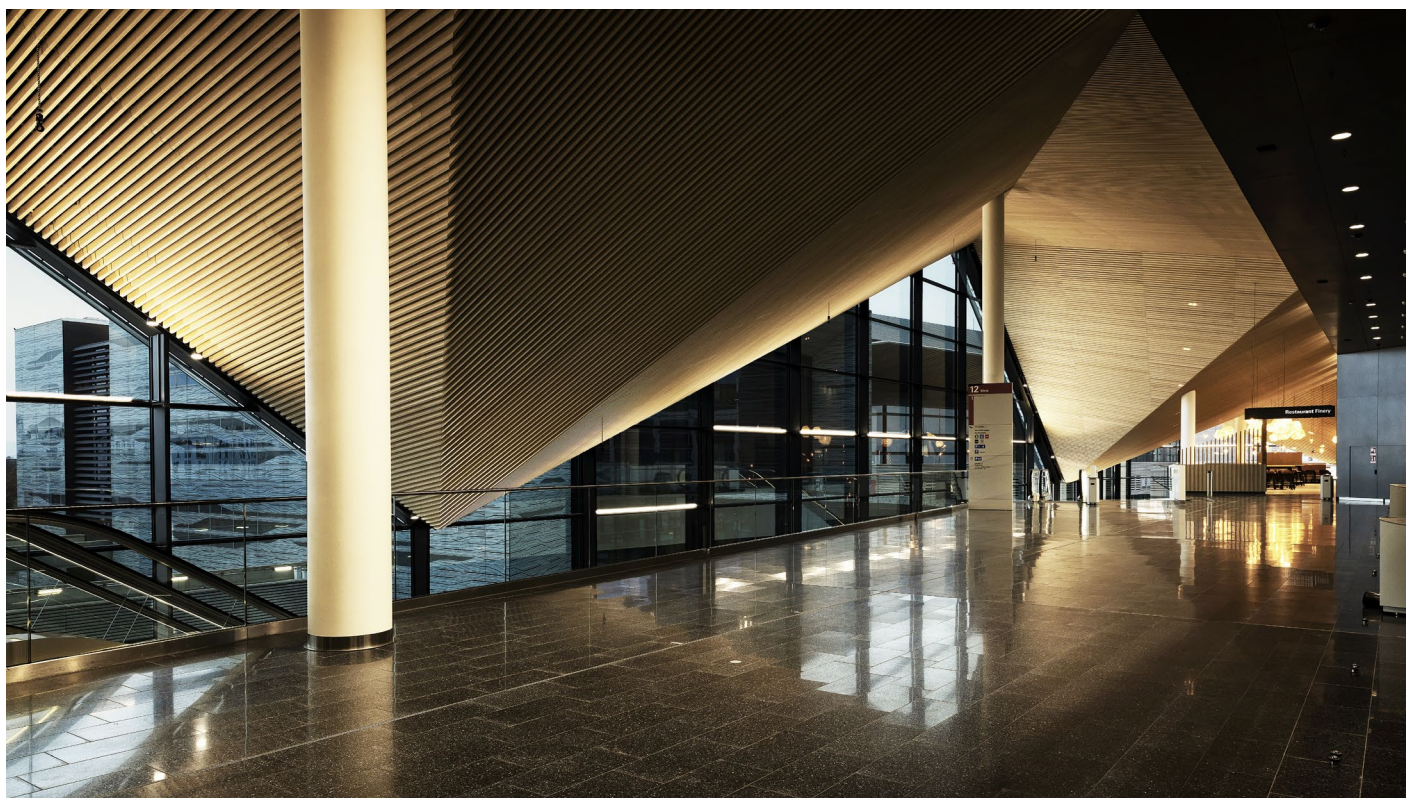
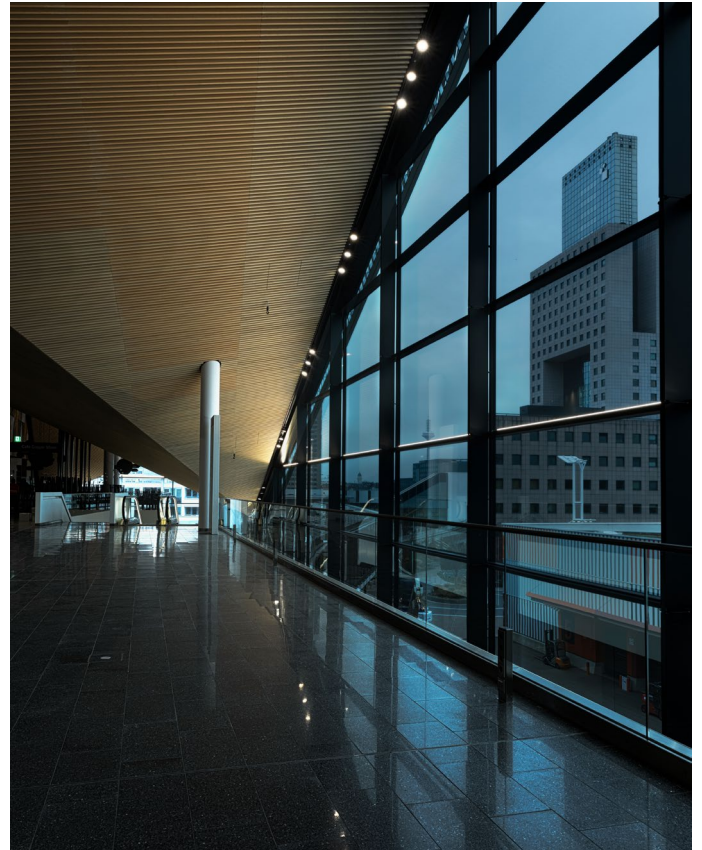

TTC Timmler Technology GmbH  
Christian-Schäfer-Straße 8  
D-53881 Flammersheim [Cologne/Bonn]  
T +49 2255 9212-00  
F +49 2255 9212-99  
E [info@ado-lights.com](mailto:info@ado-lights.com)  
I [www.ado-lights.com](http://www.ado-lights.com)  
[www.led-luc.com](http://www.led-luc.com)

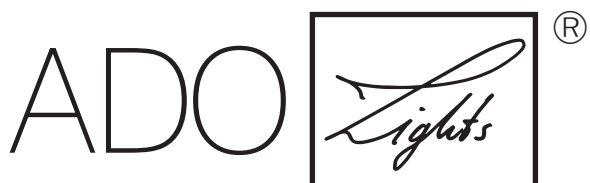

by TTC Timmler Technology

